

SAF 500

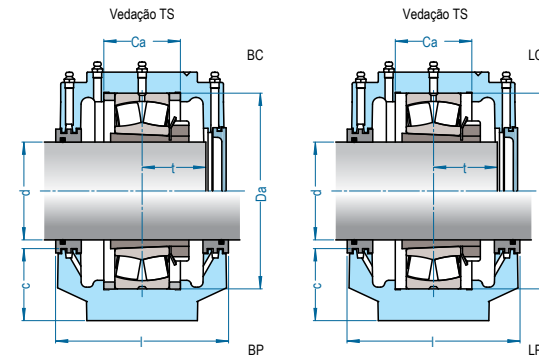

Eixo Ød		Mancal		Montagem			Cargas (kgf)		Limite Rotação RPM	Dimensão nominal (mm)														Parafuso		C (nível de óleo)	Peso (kg)	
pol.	mm	4 furos na base	2 furos na base	Rolamento	Bucha de Fixação	Anel de Bloqueio	dinâmica Cr	estática Cor		h	a	e	e1	b	s1	s2	s1 ²	s2 ²	g	w	l	Ca	Da	t	SAF			FSAF
1-7/16				1209K	HA209	2 FRB 6/85	2290	780	11000																			
				2209K	HA309	2 FRB 4/85	3250	1060	10000																			
				22209K	HA309	2 FRB 4/85	10200	9800	10000																			
1-1/2		-	SAF 509	1209K	HE209	2 FRB 6/85	2290	780	11000																			
				2209K	HE309	2 FRB 4/85	3250	1060	10000	57,1	210	168	-	60	-	-	15	25	21	111	92	31	85	27	M12	-	25	5,0
				22209K	HE309	2 FRB 4/85	10200	9800	10000																			
	40			1209K	H209	2 FRB 6/85	2290	780	11000																			
				2209K	H309	2 FRB 4/85	3250	1060	10000																			
				22209K	H309	2 FRB 4/85	10200	9800	10000																			
1-11/16				1210K	HE210	2 FRB 11,5/90	2650	915	10000																			
				2210K	HE310	2 FRB 10/90	3380	1120	9500																			
				22210K	HE310	2 FRB 10/90	10400	10800	9500																			
1-3/4		-	SAF 510	1210K	HA210	2 FRB 11,5/90	2650	915	10000																			
				2210K	HA310	2 FRB 10/90	3380	1120	9500	63,5	210	170	-	60	-	-	16	23	24	120	101	43	90	28	M12	-	30	5,5
				22210K	HA310	2 FRB 10/90	10400	10800	9500																			
	45			1210K	H210	2 FRB 11,5/90	2650	915	10000																			
				2210K	H310	2 FRB 10/90	3380	1120	9500																			
				22210K	H310	2 FRB 10/90	10400	10800	9500																			
1-15/16				1211K	HA211	2 FRB 12,5/100	2760	1060	9000																			
				2211K	HA311	2 FRB 10,5/100	3900	1340	8500																			
				22211K	HA311	2 FRB 10,5/100	12500	12700	8500																			
	50	-	SAF 511	1211K	H211	2 FRB 12,5/100	2760	1060	9000																			
				2211K	H311	2 FRB 10,5/100	3900	1340	8500	69,8	245	193	-	70	-	-	19	23	25	133	111	46	100	29	M16	-	35	6,3
				22211K	H311	2 FRB 10,5/100	12500	12700	8500																			
2				1211K	HE211	2 FRB 12,5/100	2760	1060	9000																			
				2211K	HE311	2 FRB 10,5/100	3900	1340	8500																			
				22211K	HE311	2 FRB 10,5/100	12500	12700	8500																			
2-3/16				1213K	HA213	2 FRB 16,5/120	3510	1400	7000																			
				2213K	HA313	2 FRB 12,5/120	5720	200	7000																			
				22213K	HA313	2 FRB 11/120	19300	21600	7000																			
2-1/4		FSAF 513	SAF 513	1213K	HE213	2 FRB 16,5/120	3510	1400	7000																			
				2213K	HE313	2 FRB 12,5/120	5720	200	7000	76,2	279	224	51	79	15	30	19	34	25	151	114	56	120	34	M16	M12	28	8,4
				22213K	HE313	2 FRB 11/120	19300	21600	7000																			
	60			1213K	H213	2 FRB 16,5/120	3510	1400	7000																			
				2213K	H313	2 FRB 12,5/120	5720	200	7000																			
				22213K	H313	2 FRB 11/120	19300	21600	7000																			

As diferentes larguras de pista dos rolamentos são compensadas nos mancais bloqueados por anéis FRB específicos.

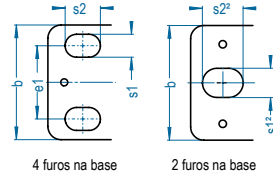
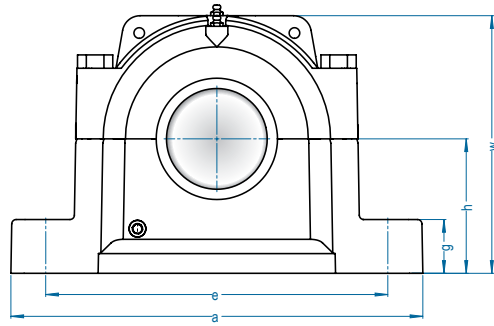